



Established 1981

Estate Agents • Residential Sales
Investments • Lettings

Woodside Park Office:

14/14A Sussex Ring
Woodside Park
London N12 7HX

Telephone: 020 8445 6387

Fax: 020 8445 4492

Email: info@realestates-wsp.co.uk

www.realestates-wsp.co.uk



Lorian Close
Woodside Park N12 7DW
£795,000 Freehold

Totteridge Office:

74 Totteridge Lane, Totteridge, London N20 8QG **Tel: 020 8445 3132 Fax: 020 8445 4492** Email: totteridge@realestates-wsp.co.uk

Real Estates on behalf of themselves and for the vendors of these properties whose agents they are, give notice that: (1) These particulars or any part of these particulars do not constitute a contract or an offer. (2) All statements made in these particulars relating to these properties are made without responsibility on the part of Real Estates or the Vendor. (3) Any intending purchaser must satisfy himself by inspection or otherwise as to the correctness of these particulars. (4) Real Estates or any person in their employment has no authority to make or give any warranty or representation whatever in relation to these properties.

Lorian Close , Woodside Park

A rare opportunity to acquire an END OF TERRACE TOWNHOUSE situated in a popular location, within walking distance to Woodside Park Northern Line tube station.

The accommodation, arranged over 3 floors, comprises guest cloakroom, tv room/study, fitted kitchen/breakfast room, lounge, 2 bathrooms (1 en suite), off street parking and rear garden.

ENTRANCE HALL

GUEST CLOAKROOM

TV ROOM/STUDY 15'6 max x 9'4 max (4.72m max x 2.84m max)

KITCHEN/BREAKFAST ROOM 15' max x 12'2 (4.57m max x 3.71m)

1ST FLOOR:

RECEPTION 15'7 x 15'1 (4.75m x 4.60m)

BEDROOM 15'1 into cupboard x 12'4 (4.60m into cupboard x 3.76m)
With En Suite Bathroom.

2ND FLOOR:

BEDROOM 15'1 x 9'10 (4.60m x 3.00m)

BEDROOM 12'11 x 7'5 (3.94m x 2.26m)

BEDROOM 12'11 x 7'4 (3.94m x 2.24m)

FAMILY BATHROOM

SEPARATE WC

EXTERIOR:

REAR GARDEN 33'10 x 19'10 max (10.31m x 6.05m max)

Viewing:

By prior appointment with the vendors agent Real Estates Tel: 020 8445 6387

You may download, store and use the material for your own personal use and research. You may not republish, retransmit, redistribute or otherwise make the material available to any party or make the same available on any website, online service or bulletin board of your own or of any other party or make the same available in hard copy or in any other media without the website owner's express prior written consent. The website owner's copyright must remain on all reproductions of material taken from this website.

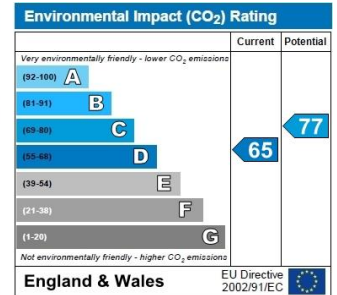
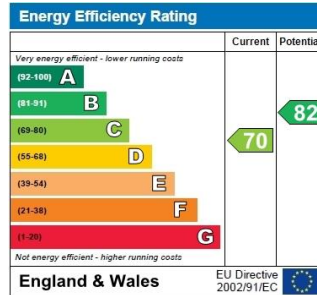



GROUND FLOOR

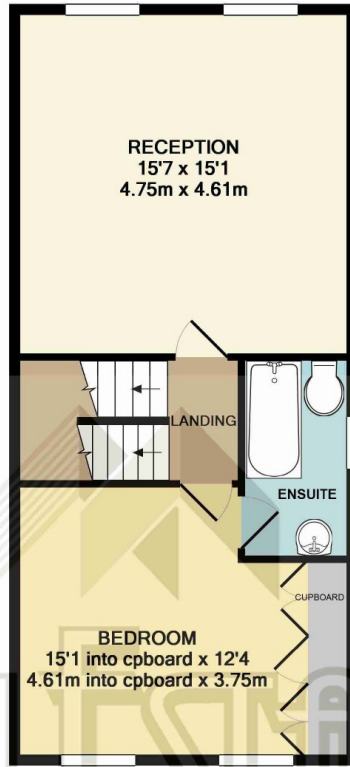

1ST FLOOR

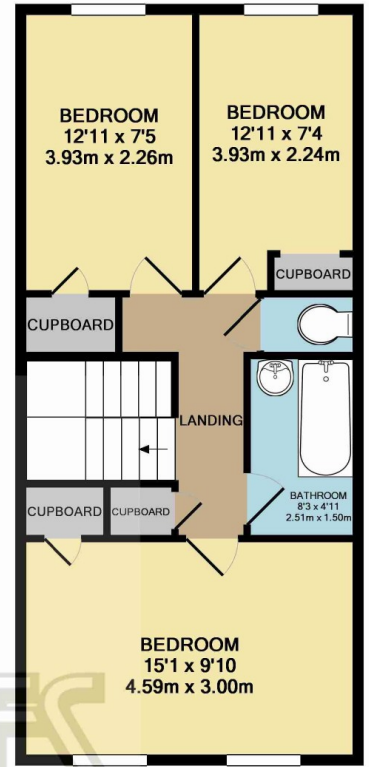

2ND FLOOR

Established 1981

(EXCLUDES EXTERNAL STORAGE)
TOTAL APPROX. FLOOR AREA 1501 SQ.FT. (139.4 SQ.M.)

