



Estate Agents - Residential Sales - Investments - Lettings

**Woodside Park office:**

14/14a Sussex Ring  
Woodside Park  
London N12 7HX

e : [info@realestates-wsp.co.uk](mailto:info@realestates-wsp.co.uk)

t : 020 8445 6387

f : 020 8445 4492

w : [www.realestates-wsp.co.uk](http://www.realestates-wsp.co.uk)



**Tillingham Way**  
**Woodside Park N12 7EN**  
**£3,649 Per calendar month**

**Totteridge office:**

74 Totteridge Lane - Totteridge - London N20 8QG

t : 020 8445 3132

f : 020 8445 4492

e : [totteridge@realestates-wsp.co.uk](mailto:totteridge@realestates-wsp.co.uk)

Real Estates on behalf of themselves and for the vendors of these properties whose agents they are, give notice that: (1) These particulars or any part of these particulars do not constitute a contract or an offer. (2) All statements made in these particulars relating to these properties are made without responsibility on the part of Real Estates or the Vendor. (3) Any intending purchaser must satisfy himself by inspection or otherwise as to the correctness of these particulars. (4) Real Estates or any person in their employment has no authority to make or give any warranty or representation whatever in relation to these properties.

# Tillingham Way , Woodside Park

A substantial 5/6 bedroom detached family home situated in the heart of Woodside Park, within easy walking distance of Woodside Park Northern Line tube station and local shopping facilities.

\* GUEST CLOAK/SHOWER ROOM \* LOUNGE \* DINING ROOM \* FURTHER RECEPTION ROOM \* STUDY/BEDROOM 6 \* MASTER BEDROOM WITH EN SUITE \* 4 FURTHER BEDROOMS \* FAMILY BATHROOM \* SINGLE INTEGRAL GARAGE \* OFF STREET PARKING \* FURNISHED/UNFURNISHED \*

**ENTRANCE HALL**

**GUEST CLOAK/SHOWER ROOM**

**RECEPTION 17'10 into bay x 14'10 max (5.44m into bay x 4.52m max)**

**RECEPTION 16'7 x 11'10 (5.05m x 3.61m)**

**RECEPTION 16'1 into bay x 12'4 (4.90m into bay x 3.76m)**

**KITCHEN 23' x 9'10 (7.01m x 3.00m)**

**1ST FLOOR:**

**BEDROOM 17'11 into bay x 14' max (5.46m into bay x 4.27m max)**

**EN SUITE BATHROOM**

**BEDROOM 16'4 into bay x 12'4 (4.98m into bay x 3.76m)**

**BEDROOM 14'8 x 13'7 max (4.47m x 4.14m max)**

**BEDROOM 11'10 x 10' (3.61m x 3.05m)**

**BEDROOM 11'11 x 9'10 (3.63m x 3.00m)**

**FAMILY BATHROOM**

**EXTERIOR:**

**REAR GARDEN 50'9 max x 49'7 max (15.47m max x 15.11m max)**

**GARAGE 16'7 max x 9'11 (5.05m max x 3.02m)**

## Viewing:

By prior appointment with the vendors agent Real Estates Tel: 020 8445 6387

You may download, store and use the material for your own personal use and research. You may not republish, retransmit, redistribute or otherwise make the material available to any party or make the same available on any website, online service or bulletin board of your own or of any other party or make the same available in hard copy or in any other media without the website owner's express prior written consent. The website owner's copyright must remain on all reproductions of material taken from this website.

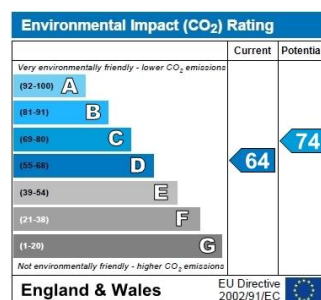
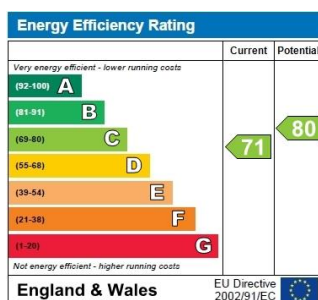



GROUND FLOOR

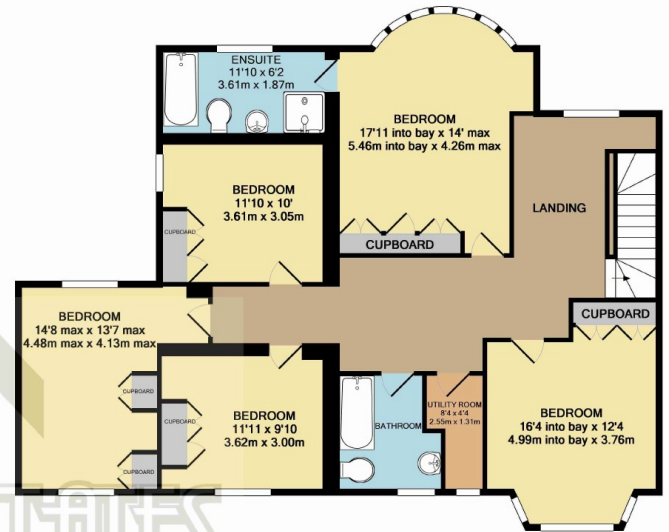

1ST FLOOR

(EXCLUDES GARAGE)  
TOTAL APPROX. FLOOR AREA 2473 SQ. FT. (229.7 SQ. M.)

