



Cissbury Ring North, Woodside Park, N12 7AN
£3,200 Per calendar month

A 4 bedroom 2 bathroom DETACHED house in this sought after residential location, within the catchment area for FRITH MANOR PRIMARY SCHOOL and close to local shops, bus services, parks and Woodside Park Northern Line tube station.

Arranged over 3 floors, the spacious accommodation comprises thru lounge/diner, guest cloakroom, fitted kitchen, master bedroom with en suite shower, 3 further bedrooms and a family bathroom.

* AVAILABLE BEGINNING SEPT 2021 * FURNISHED/ UNFURNISHED *

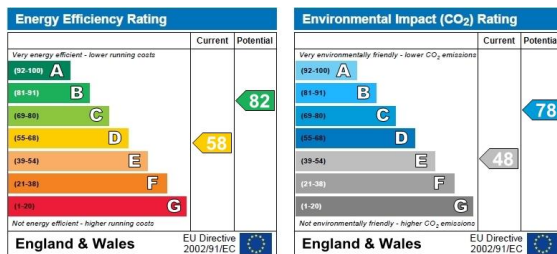
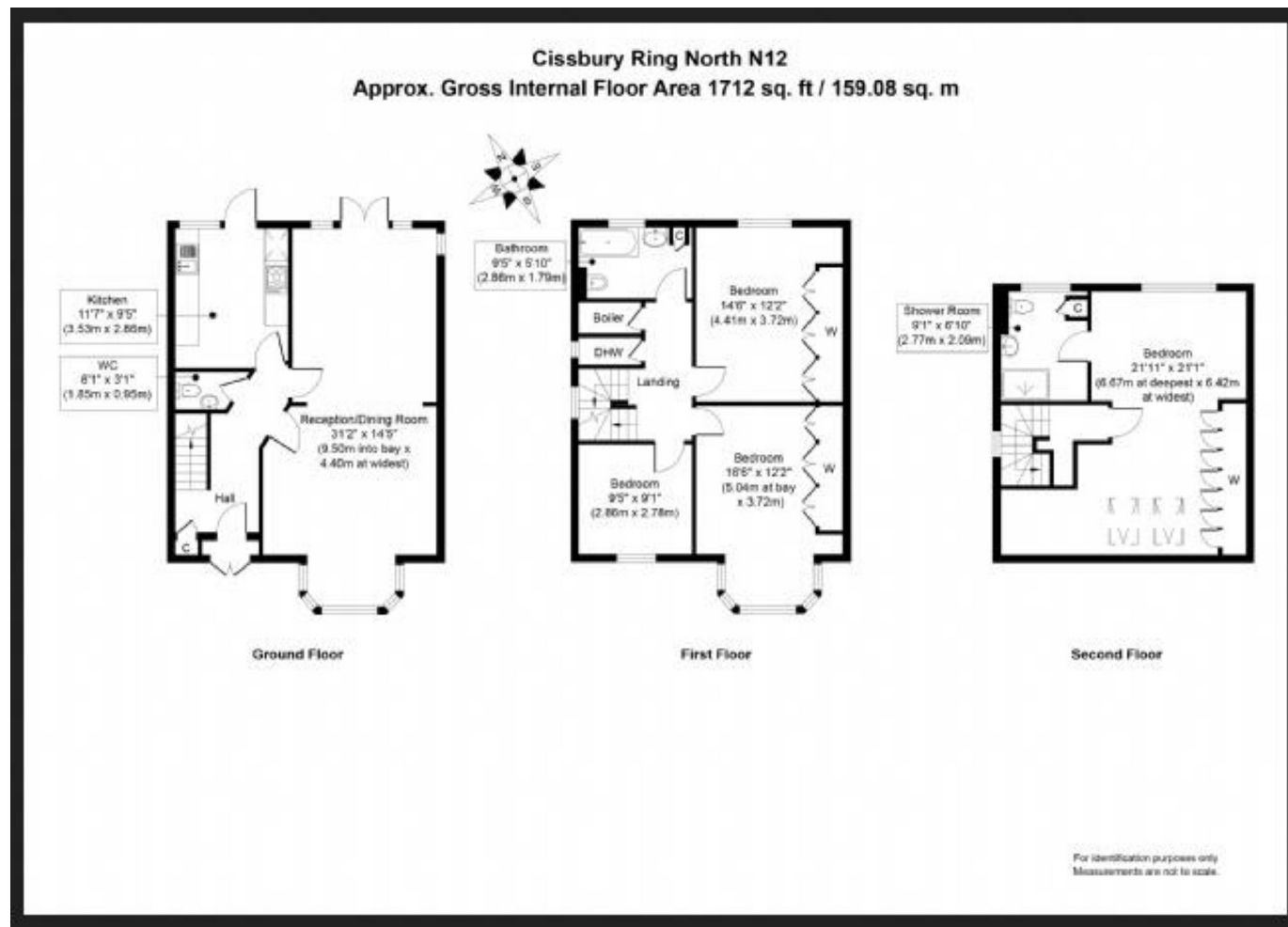

Woodside Park office: 14/14a Sussex Ring, Woodside Park, London N12 7HX

e : info@realestates-wsp.co.uk

t : 020 8445 6387

f : 020 8445 4492

w : www.realestates-wsp.co.uk



REAL ESTATES

Estate Agents - Residential Sales - Investments - Lettings