



Chanctonbury Way, Woodside Park, N12 7AB
£3,500 Per Calendar Month Council Tax Band F

REAL ESTATES
Est.1981

Estate Agents · Residential Sales · Investments · Lettings

*AVAILABLE 19 MAY * FURNISHED/UNFURNISHED * A 3 bedroom semi-detached property situated in the heart of Woodside Park, within easy reach of Woodside Park's Northern Line tube station, local shops, schools and parkland.

* LOUNGE * DINING ROOM * FITTED KITCHEN/BREAKFAST ROOM
* GUEST CLOAKROOM * 3 BEDROOMS * BATHROOM/WC * REAR GARDEN * OFF STREET PARKING * AVAILABLE 19 MAY
*FURNISHED/UNFURNISHED

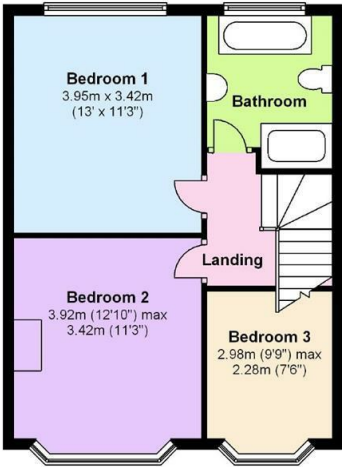
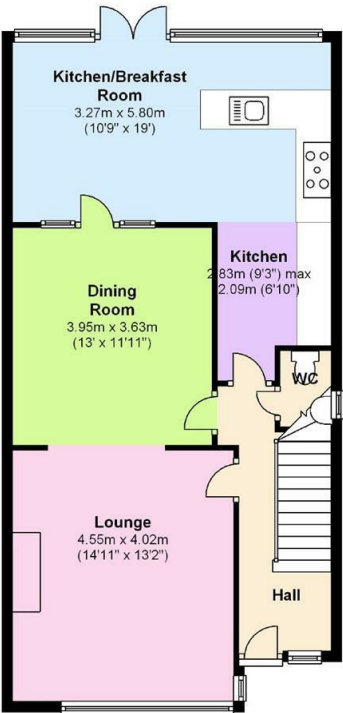

Total area: approx. 109.5 sq. metres (1178.3 sq. feet)

