

Beecholme, Woodside Park, N12 8RT
Offers in excess of £300,000



REAL ESTATES

Estate Agents - Residential Sales - Investments - Lettings

***CASH BUYERS ONLY * CHAIN FREE * A 2 BEDROOM**
1ST FLOOR DUPLEX FLAT in this purpose built block
 close to Woodside Park Northern Line tube station.
 Shopping facilities at North Finchley High Road are
 within walking distance.

The property requires complete modernisation and has
 the benefit of a balcony overlooking well maintained
 communal gardens and allocated parking space. **SHARE**
OF FREEHOLD.

Years Remaining: 951

Ground Rent : SOF

Service Charge : £2850 pa approx

Woodside Park Road, London, N12

Approximate Area = 575 sq ft / 53.4 sq m

For identification only - Not to scale

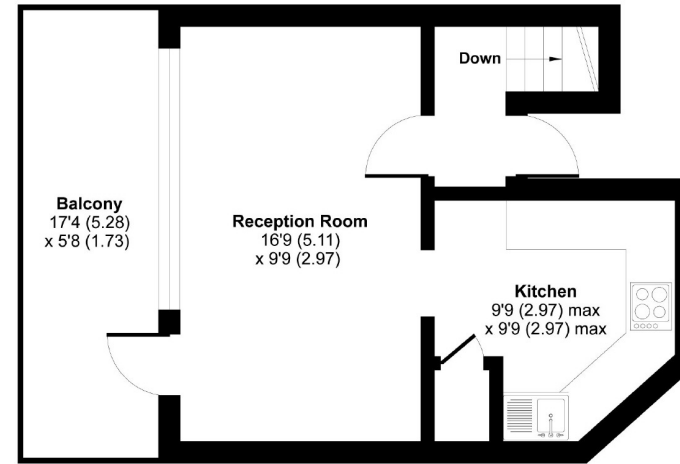

FIRST FLOOR

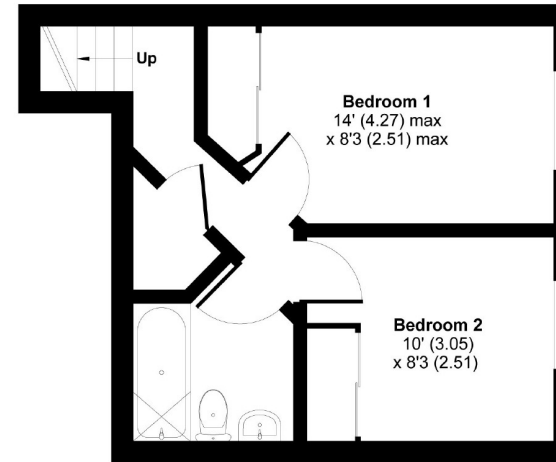

GROUND FLOOR

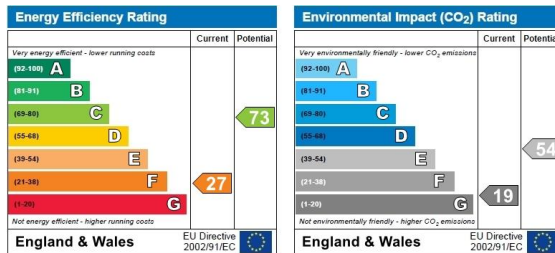

Floor plan produced in accordance with RICS Property Measurement Standards incorporating International Property Measurement Standards (IPMS2 Residential). © nichcom 2020. Produced for Real Estates. REF: 629142

Woodside Park office: 14/14a Sussex Ring, Woodside Park, London N12 7HX

e : info@realestates-wsp.co.uk

t : 020 8445 6387

f : 020 8445 4492

w : www.realestates-wsp.co.uk



REAL ESTATES

Estate Agents - Residential Sales - Investments - Lettings