



Oakleigh Park North, Oakleigh Park, N20 9AR
Guide price £2,000,000



REAL ESTATES

Estate Agents - Residential Sales - Investments - Lettings

Real Estates are delighted to offer for sale this 6 BEDROOM DETACHED home situated in one of Oakleigh Park's premier roads, close to Oakleigh Park Main Line station, Totteridge & Whetstone Northern Line station and local amenities at Whetstone High Road.

The property, offering approx 3600 sq ft, does require some updating but lends itself to a family looking to create their own stamp. Benefits also included a DOUBLE GARAGE approached via a large CARRIAGE DRIVEWAY with parking for several cars and a LARGE REAR GARDEN extending to approx 160 ft.

Further potential to extend subject to planning.

Early viewing highly recommended via the sellers sole agent.





Oakleigh Park North, Oakleigh Park, N20

Approximate Area = 3631 sq ft / 337.3 sq m (includes garage)

Outbuilding = 68 sq ft / 6.3 sq m

Total = 3699 sq ft / 343.6 sq m

For identification only - Not to scale

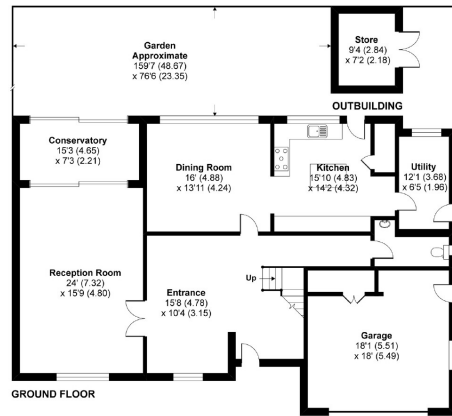
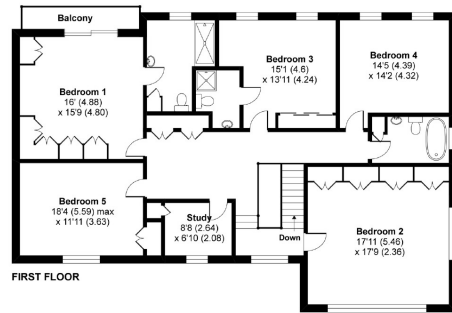

Floor plan produced in accordance with RICS Property Measurement Standards incorporating International Property Measurement Standards (IPMS2 Residential). ©richrecom 2020. Produced for Real Estates. REF: 026267.

Energy Efficiency Rating		Environmental Impact (CO ₂) Rating	
Current	Potential	Current	Potential
Very energy efficient - lower rating costs		Very environmentally friendly - lower CO ₂ emissions	
A (92-100)		A (92-100)	
B (81-91)		B (81-91)	
C (69-80)		C (69-80)	
D (55-68)		D (55-68)	
E (39-54)		E (39-54)	
F (21-38)		F (21-38)	
G (1-20)		G (1-20)	
Not energy efficient - higher running costs		Not environmentally friendly - higher CO ₂ emissions	
61	77	53	72
England & Wales	EU Directive 2002/91/EC	England & Wales	EU Directive 2002/91/EC



Totteridge office: 74 Totteridge Lane, Totteridge, London N20 8QG

e : totteridge@realestates-wsp.co.uk

t : 020 8445 3132

f : 020 8445 4492

w : www.realestates-wsp.co.uk



REAL ESTATES

Estate Agents - Residential Sales - Investments - Lettings