



Westbury Road, Woodside Park, N12 7PD
£899,950

A delightful halls-adjointing semi-detached property built in the 1920s and situated in a quiet turning close to parkland and within easy walking distance to local shops, bus services and both Woodside Park and West Finchley Northern Line tube stations. Also situated within school catchment area.

Westbury Road, London, N12

Approximate Area = 1319 sq ft / 123 sq m

For identification only - Not to scale

Presented in good condition throughout and with a mature rear garden, viewing is highly recommended to appreciate this delightful family home which also has the benefit of double glazing and some original period features,

* 4 BEDROOMS * BATHROOM * SEP WC * KITCHEN/ BREAKFAST ROOM * LOUNGE * DINING ROOM * DOUBLE GLAZING * GAS CH * MATURE REAR GARDEN * OFF STREET PARKING FOR 2 VEHICLES * POTENTIAL TO EXTEND (STPP) IF REQUIRED *

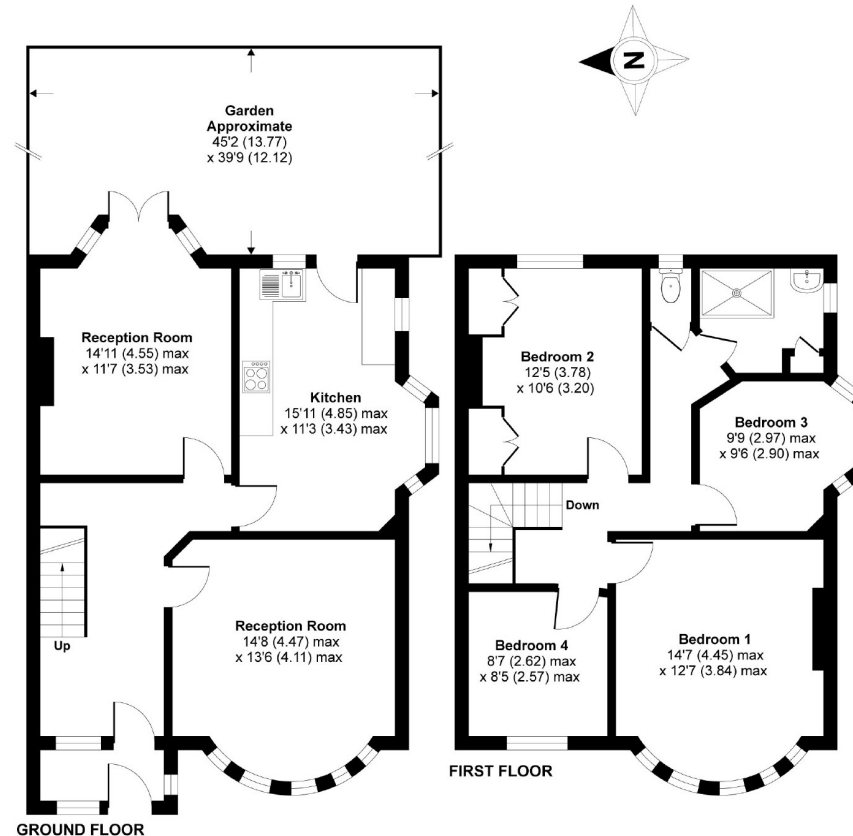
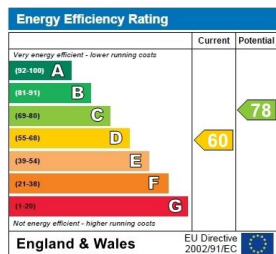

Floor plan produced in accordance with RICS Property Measurement Standards incorporating International Property Measurement Standards (IPMS2 Residential). © rihocom 2020. Produced for Real Estates. REF: 660476

Woodside Park office: 14/14a Sussex Ring, Woodside Park, London N12 7HX

e : info@realestates-wsp.co.uk

t : 020 8445 6387

f : 020 8445 4492

w : www.realestates-wsp.co.uk



REAL ESTATES

Estate Agents - Residential Sales - Investments - Lettings