



Poynings Way, Woodside Park, N12 7LP
Offers in the region of £1,150,000



REAL ESTATES

Estate Agents - Residential Sales - Investments - Lettings

OFFERED CHAIN FREE - An opportunity to acquire a 5 BEDROOM DETACHED family house situated in a sought after cul-de-sac, close to parks, local shops and within walking distance to both Woodside Park and West Finchley Station Northern Line tube stations.

The spacious accommodation includes a thru drawing room/lounge/dining room, separate family room and study, guest cloak/shower room, kitchen/breakfast room and utility room to the ground floor. The 1st floor comprises 5 bedrooms and 2 bathrooms.

There is a good size rear garden which has been well maintained with an abundance of mature shrubs and trees. To the front, there is a garage via own driveway providing off street parking.

This property requires modernisation and offers potential to extend if required (STPP).

Poynings Way, London, N12

Approximate Area = 1994 sq ft / 185.2 sq m (includes garage)

For identification only - Not to scale

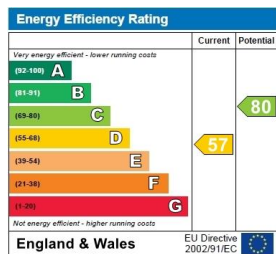
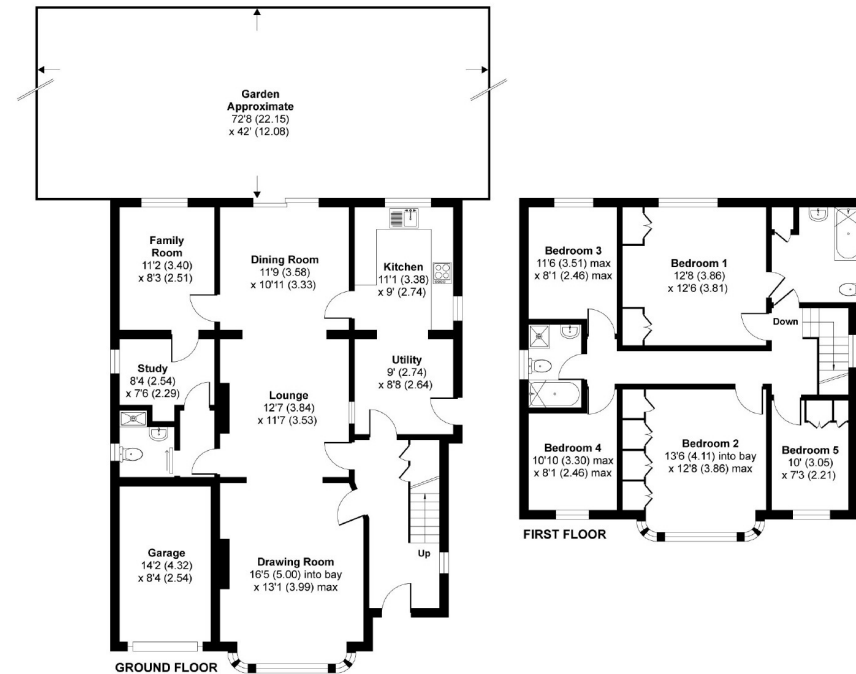

Floor plan produced in accordance with RICS Property Measurement Standards incorporating International Property Measurement Standards (IPMS2 Residential). © ritchecom 2020. Produced for Real Estates. REF: 669875

Woodside Park office: 14/14a Sussex Ring, Woodside Park, London N12 7HX

e : info@realestates-wsp.co.uk

t : 020 8445 6387

f : 020 8445 4492

w : www.realestates-wsp.co.uk



REAL ESTATES

Estate Agents - Residential Sales - Investments - Lettings