



Southway, Totteridge, N20 8EA  
Guide price £1,750,000



REAL ESTATES

Estate Agents - Residential Sales - Investments - Lettings

EARLY VIEWING IS HIGHLY RECOMMENDED OF THIS RARELY AVAILABLE 4 BEDROOM, 2 BATHROOM DETACHED HOME, situated in the HEART OF TOTTERIDGE, convenient for Totteridge & Whetstone Northern Line tube station and multiple shops at Whetstone High Road.

Well presented throughout, this property offers further potential to enhance (STTP) and benefits from a mature rear garden measuring approx 100 ft and own driveway.

For further information or an appointment to view, please contact Please contact Sole Agent Real Estates on 020 8445 3132.





# Southway, London, N20

Approximate Area = 1912 sq ft / 178 sq m

For identification only - Not to scale

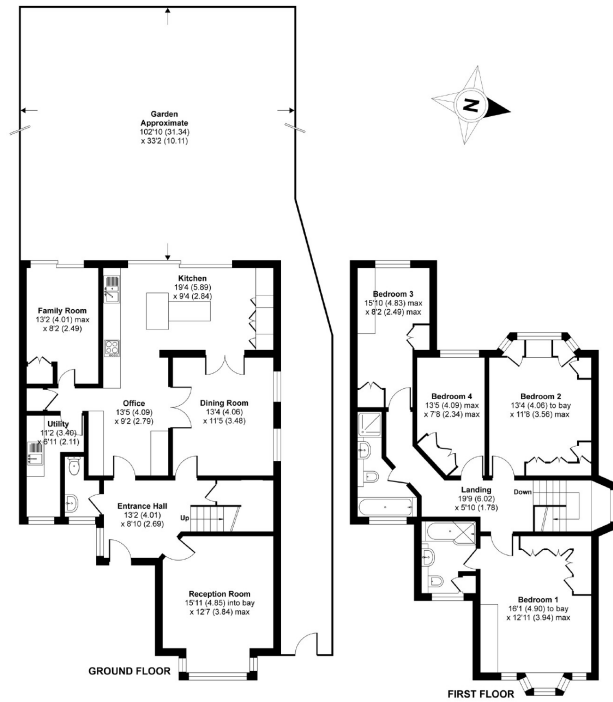

**RICS Certified Property Measurer** Floor plan produced in accordance with RICS Property Measurement Standards incorporating International Property Measurement Standards (IPMS2 Residential). ©richscom 2021. Produced for Real Estates. REF: 714610

Energy Efficiency Rating		Current	Potential
Very energy efficient - lower running costs	A		
B			
C			73
D			
E		45	
F			
G			
Not energy efficient - higher running costs			

England & Wales EU Directive 2002/91/EC



**Totteridge office:** 74 Totteridge Lane, Totteridge, London N20 8QG

e : totteridge@realestates-wsp.co.uk

t : 020 8445 3132

f : 020 8445 4492

w : www.realestates-wsp.co.uk



**REAL ESTATES**

Estate Agents - Residential Sales - Investments - Lettings