



Gainsborough Road, Woodside Park, N12 8AH
Offers in excess of £800,000



REAL ESTATES

Estate Agents - Residential Sales - Investments - Lettings

OFFERED CHAIN FREE - A 3 BEDROOM SEMI-DETACHED HOUSE situated on a corner plot, in this popular residential road, within easy walking distance to Woodside Park Northern Line tube station, local shops, cafes and parkland.

Although in need of modernisation, this property offers lots of potential for the purchaser to create their own bespoke home.

The accommodation comprises 2 reception rooms, kitchen, breakfast room, 3 bedrooms, family bathroom and separate wc.

Externally, there is a garage at rear, own driveway and wrap-around garden.

* POTENTIAL TO EXTEND (STPP) *

Gainsborough Road, London, N12

Approximate Area = 1487 sq ft / 138.1 sq m (includes garage)

For identification only - Not to scale

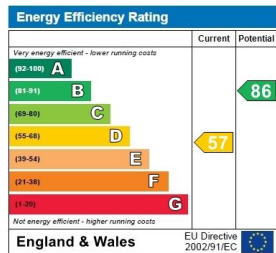
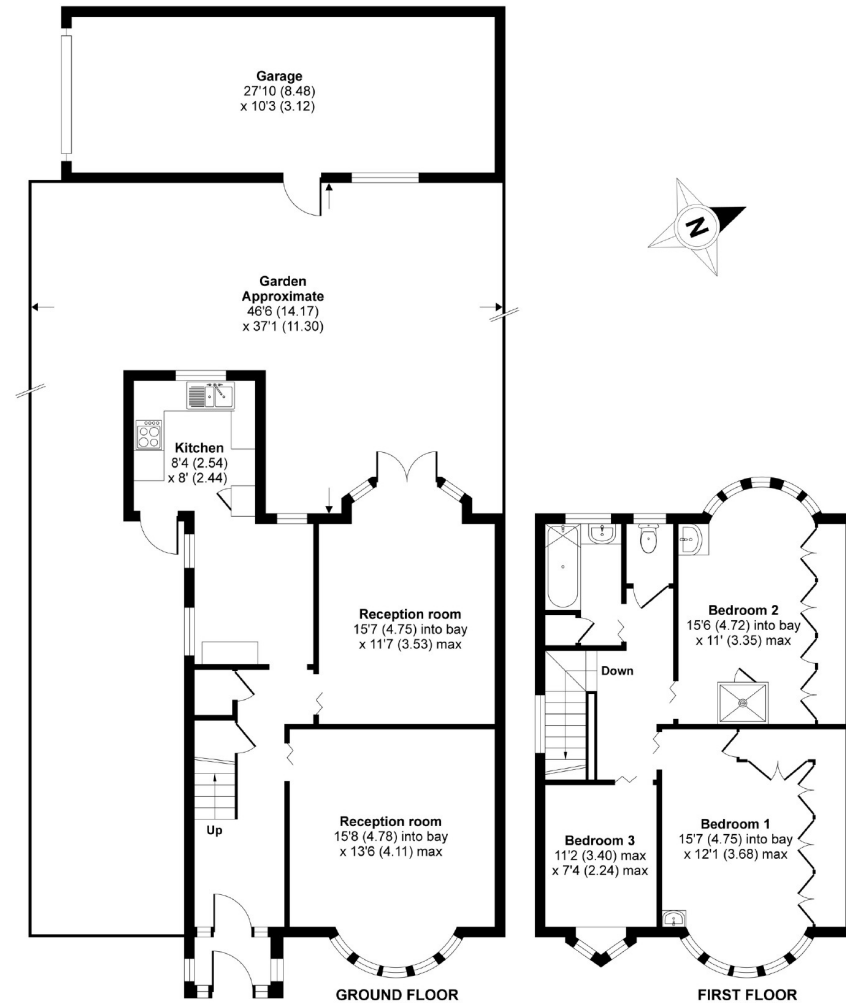

Floor plan produced in accordance with RICS Property Measurement Standards incorporating International Property Measurement Standards (IPMS2 Residential). © nichcom 2021. Produced for Real Estates. REF: 724852

Woodside Park office: 14/14a Sussex Ring, Woodside Park, London N12 7HX

e : info@realestates-wsp.co.uk

t : 020 8445 6387

f : 020 8445 4492

w : www.realestates-wsp.co.uk



REAL ESTATES

Estate Agents - Residential Sales - Investments - Lettings