



Courthouse Road, Woodside Park, N12 7PH
Offers in excess of £800,000



REAL ESTATES

Estate Agents - Residential Sales - Investments - Lettings

OFFERED CHAIN FREE and with POTENTIAL TO EXTEND (stpp), a 3 BEDROOM SEMI-DETACHED FAMILY HOME with the benefit of a GARAGE via OWN DRIVE as well as a NEWLY FITTED KITCHEN AND BATHROOM.

The property is situated within easy walking distance to West Finchley Northern Line tube station, local shops, cafes, parkland and within school catchment area.

FOR FURTHER INFORMATION/APPOINTMENT TO VIEW PLEASE CONTACT SOLE AGENT REAL ESTATES on 020 8445 6387.

Courthouse Road, London, N12

Approximate Area = 1172 sq ft / 109 sq m (includes garage)

For identification only - Not to scale

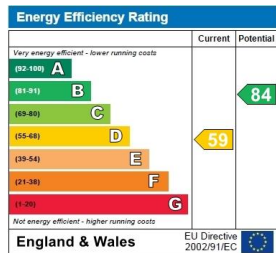
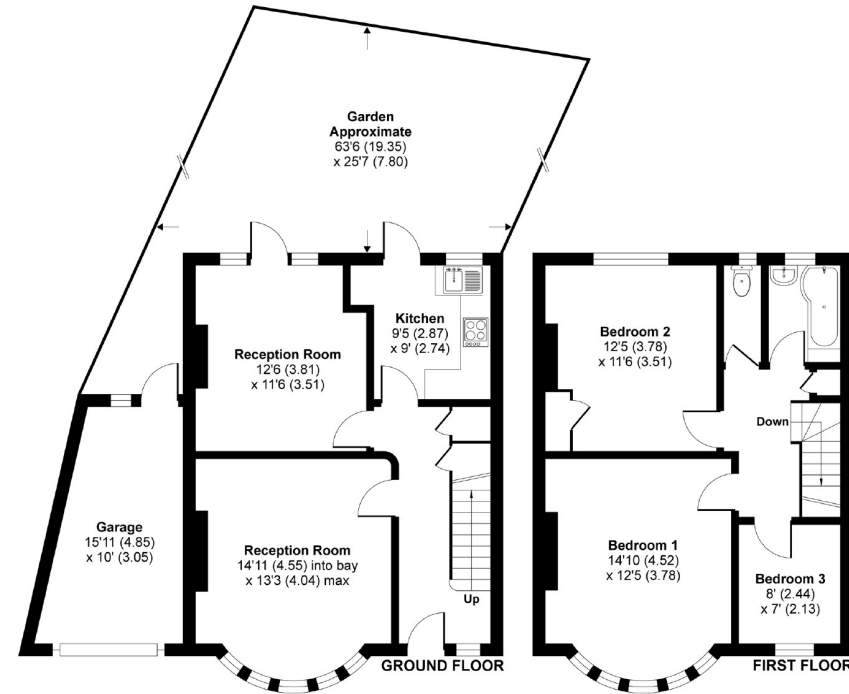

Floor plan produced in accordance with RICS Property Measurement Standards incorporating International Property Measurement Standards (IPMS2 Residential). © nichcom 2021. Produced for Real Estates. REF: 779280

Woodside Park office: 14/14a Sussex Ring, Woodside Park, London N12 7HX

e : info@realestates-wsp.co.uk

t : 020 8445 6387

f : 020 8445 4492

w : www.realestates-wsp.co.uk



REAL ESTATES

Estate Agents - Residential Sales - Investments - Lettings