

Holden Road, Woodside Park, N12 7AW  
£2,350 Per Calendar Month      Council Tax Band G

**REAL ESTATES**  
Est.1981

Estate Agents · Residential Sales · Investments · Lettings

\* A 2 BEDROOM 2 BATHROOM 1ST FLOOR APARTMENT in this converted church, offering fantastic character features and the benefit of an UNDERGROUND PARKING SPACE.

Situated within a stone's throw to Woodside Park NORTHERN LINE tube station, various bus routes and green walks as well as being within walking distance of local coffee shops and convenience store.

MODERN FITTED KITCHEN, BATHROOM & SHOWER ROOM \*

## Holden Road, London, N12

Approximate Area = 1008 sq ft / 93.6 sq m

For identification only - Not to scale

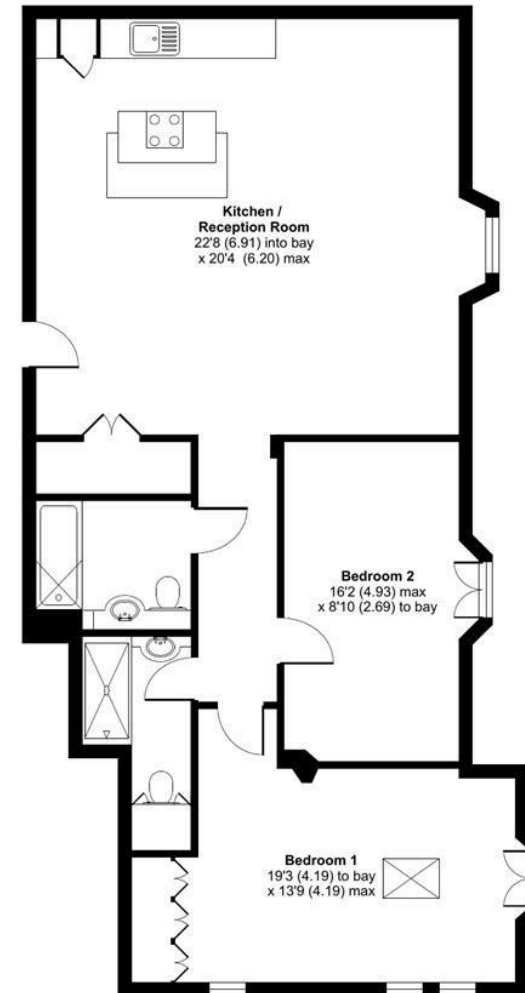

FIRST FLOOR

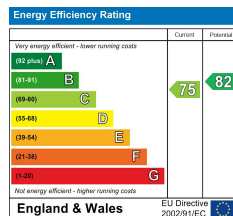

Floor plan produced in accordance with RICS Property Measurement Standards incorporating International Property Measurement Standards (IPMS2 Residential). © nichecom 2022. Produced for Real Estates. REF: 675810