



Greenway Close, Totteridge, N20 8ES
Guide Price £1,450,000 Freehold Council Tax Band G

REAL ESTATES
Est.1981

Estate Agents · Residential Sales · Investments · Lettings

SOLD OFF MARKET- A rare opportunity to acquire a well presented 4 bedroom detached home in this sought after cul-de-sac, boasting a south facing rear garden.

Greenway Close is conveniently situated within easy reach of Totteridge & Whetstone Northern Line tube station, as well as multiple shopping facilities and restaurants at Whetstone High Road.







Greenway Close, London

Approximate Area = 1975 sq ft / 183 sq m
Outbuilding = 112 sq ft / 10 sq m
Total = 2078 sq ft / 193 sq m
For identification only - Not to scale

Energy Efficiency Rating		Current	Potential
Very energy efficient - lower running costs	A		
Energy efficient - lower running costs	B		
Decent energy efficiency - lower running costs	C		
Some energy efficiency - lower running costs	D		
Not very energy efficient - higher running costs	E		
Very poor energy efficiency - higher running costs	F		
Extremely poor energy efficiency - higher running costs	G		
		64	75

EU Directive

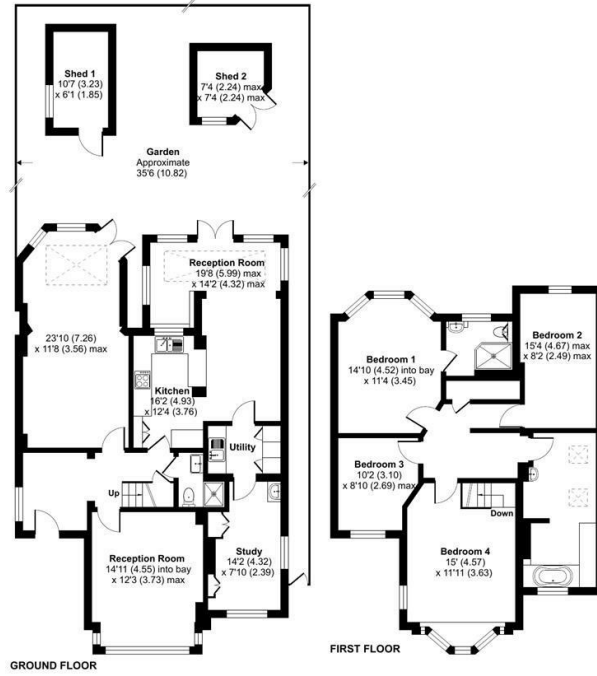

Certified Property Measurer Floor plan produced in accordance with RICS Property Measurement Standards incorporating International Property Measurement Standards (IPMS Residential). © rnhccom 2022. Produced for Real Estates - REF: 82984



Real EstatesTotteridge Office:
32 Totteridge Lane
Totteridge N20 9QJ

ll : 0208 445 3132
e : info@realestates-wsp.co.uk
w : www.realestates-wsp.co.uk