



Pine Grove, Totteridge, N20 8LB

£9000 PCM

Council Tax Band H

REAL ESTATES
Est.1981

Estate Agents · Residential Sales · Investments · Lettings

***AVAILABLE 1st JUNE* UNFURNISHED ***

Real Estates are delighted to bring to the market this substantial 6 BEDROOM 3 BATHROOM 3 RECEPTION DETACHED FAMILY HOME located in one of the most prestigious roads in Totteridge, within easy reach of Totteridge & Whetstone Northern Line tube station and Whetstone High Road.





Pine Grove, London, N20

Approximate Area = 3129 sq ft / 290.7 sq m
 Limited Use Area(s) = 76 sq ft / 7.1 sq m
 Outbuilding(s) = 191 sq ft / 17.7 sq m
 Total = 3839 sq ft / 4713 sq m
 For identification only - Not to scale

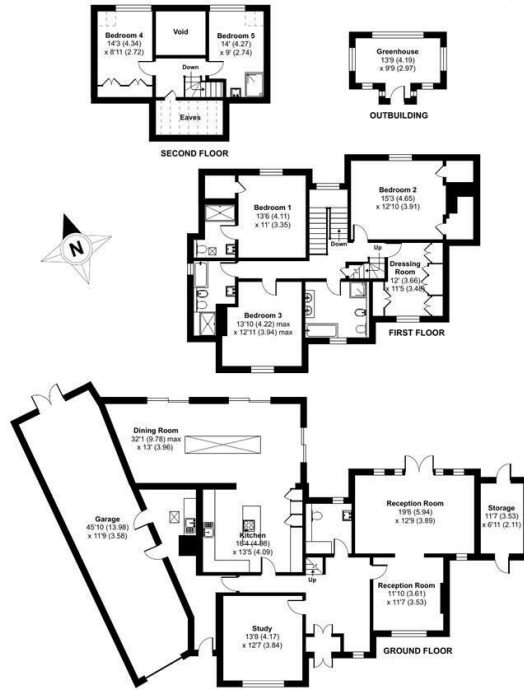

Certified Property Measurer
 Floor plan produced in accordance with RICS Property Measurement Standards incorporating International Property Measurement Standards (IPMS Residential). © ritchcom 2022. Produced for Real Estates - REF: 809189

Energy Efficiency Rating		Current	Potential
Very energy efficient - lower running costs	A		
Energy efficient - lower running costs	B		
Decent energy efficiency - lower running costs	C		
Some energy efficiency - lower running costs	D		
Energy efficiency - lower running costs	E		
Some energy efficiency - higher running costs	F		
Energy efficiency - higher running costs	G		
		72	53

EU Directive

